

PRODUCT SUBMITTAL

Series 800 Ladder Level-Eye (Hook & Eye)

WIRE-BOND

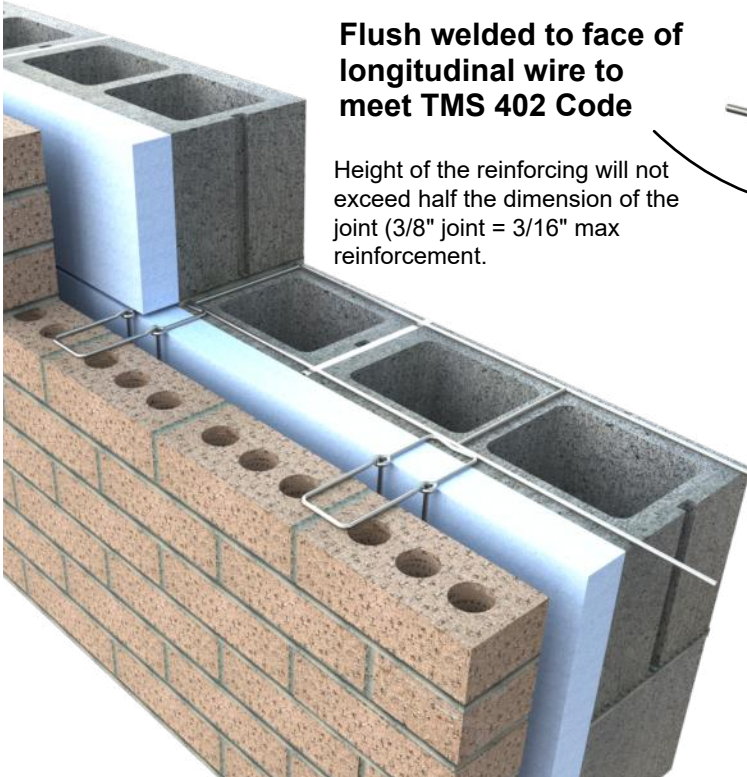

Flush welded to face of longitudinal wire to meet TMS 402 Code

Height of the reinforcing will not exceed half the dimension of the joint (3/8" joint = 3/16" max reinforcement).

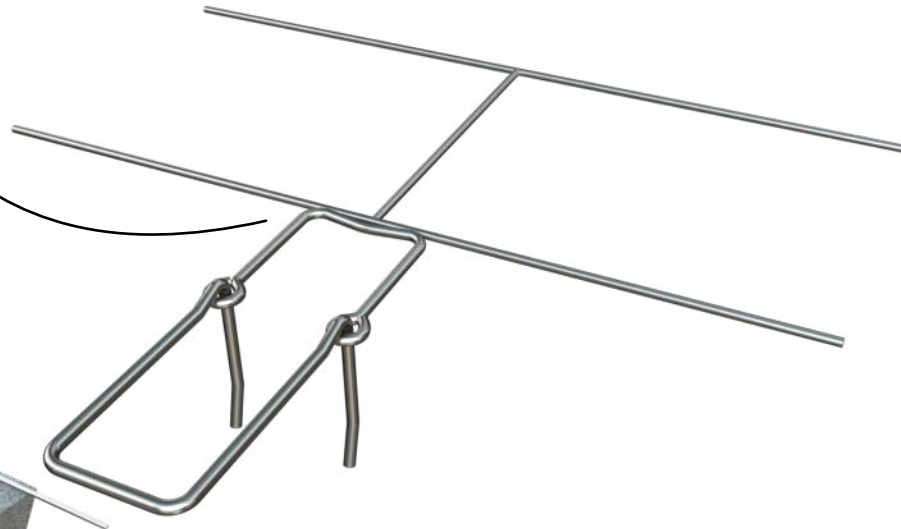

16" O.C. cross rods allow core clearance.

STRUCTURAL PERFORMANCE CHARACTERISTICS

Capable of withstanding 100 lbs load in tension and compression without deforming or developing play in excess of .05 inch.

- Double eye is butt welded to side rod 16" O.C.
- Height of double eye will not exceed 3/16" in bed joint.
- Easier to maintain 3/8" mortar joint.

MATERIAL CONFORMANCE	SIZES / FINISHES									
<p>Wire (Carbon Steel): Prefabricated from cold-drawn steel wire conforming to ASTM A1064/A1064M, ASTM A82/ A82M</p> <p>Tensile Strength - 80,000 p.s.i. Yield Point - 70,000 p.s.i. minimum</p> <p>ASTM A951/A951M (Standard Specification for Steel Wire for Masonry Joint Reinforcement)</p> <p>ACI / ASCE 530 (Building Code Requirements for Masonry Structures)</p> <p>Mill Galvanized coating: ASTM A641/A641M (0.1 oz/ft)</p> <p>Hot-Dip Galvanized after fabrication: ASTM A153/A153M-B2 (1.5 oz/ft)</p> <p>Wire (Stainless Steel): ASTM A580/ASTM 580M - AISI Type 304 (Type 316 available on special orders)</p>	<p>Hot Dip Galvanized after fabrication / Zinc Coating ASTM A153 / A 153 - B2 (1.50 oz per sq ft)</p> <p>Stainless Steel ASTM 580 / ASTM 580M Type 304 (Type 316 available on special order)</p>									
<p>Recycled Content: Mill Galvanized & Hot Dipped, 82.8% Post-Consumer 17% Post Industrial / Pre Consumer</p> <p>Stainless Steel 97% Pre-Consumer V O C Content - 0%</p>	<p>WIRE SIZE:</p> <table border="0"> <tr> <td></td> <td>Side Rods</td> <td>Cross Rods</td> </tr> <tr> <td>Standard</td> <td>9 Gauge (.148 in)</td> <td>9 Gauge</td> </tr> <tr> <td>Other</td> <td></td> <td></td> </tr> </table> <p>Note: Specs apply to single and double sided walls. Ex: 8-2-4 or 4-2-8-2-4</p>		Side Rods	Cross Rods	Standard	9 Gauge (.148 in)	9 Gauge	Other		
	Side Rods	Cross Rods								
Standard	9 Gauge (.148 in)	9 Gauge								
Other										



www.wirebond.com

MASONPRO, Inc.
43300 Seven Mile Road
Northville, MI 48167
1-800-659-4731
www.masonpro.com