



Joint Reinforcement: Less Is More

By Dan Zechmeister, PE, FASTM
and Jeff Snyder, MBA

Mason contractors are empowered to help improve joint reinforcement specifications.

DO YOU STILL ENCOUNTER PROJECT SPECIFICATIONS that require (often or occasionally) truss-shaped wire, heavy-duty wire, prefabricated corners and/or Ts? If so, it's time to climb the ladder, so your company can positively impact the constructability, performance and cost effectiveness of your client's projects.

Far too many specifications for horizontal joint reinforcement inadvertently include requirements that could undermine the capacity to meet code and negatively impact the constructability, performance and cost effectiveness of reinforced CMU wall systems. Some requirements are simply an unnecessary waste, while a few, like prefabricated Ts for intersecting walls, may even elevate safety concerns.

Mason contractors can empower themselves to intervene (prior to or during the submittal process) to educate the project designers and construction professionals with myriad code compliance and performance data available. There should be receptive ears, because no one wants to take responsibility for requiring you to proceed with an installation linked to specifications that could undermine your capacity to meet the code.

Another benefit of this exercise is, when successful, you will not only positively impact the particular project at hand with updating the designer's master specifications, but will have a domino effect on future projects.

The main objective of this article is to provide you with tools (knowledge) that support the premise "less is more," when it comes to using horizontal joint reinforcement. We begin with a brief history including why, where and what wire is, including many factors that impact its use. We also touch on corners, intersections and finishes. Finally, we present a gener-

ic specification that provides IBC and TMS Code compliance with an eye on improved constructability and economy.

History

ACCORDING TO THE National Concrete Masonry Association (NCMA) TEK 12-2B (2005) Joint Reinforcement for Concrete Masonry: "It was initially conceived primarily to control wall cracking associated with horizontal thermal or moisture shrinkage or expansion and as an alternative to masonry headers when tying masonry wythes together."

This TEK Note goes on to state that it "...also increases a wall's resistance to horizontal bending, but is not widely recognized by the model building codes for structural purposes."

The most dramatic design change in single- and multiwythe masonry walls, since wire reinforcement became the norm in the 1960s, was the shift to vertical and horizontal steel reinforcement (rebar) in CMU (block) in the 1990s. This encompassed all of North America's unreinforced markets, not just seismic zones.

According to NCMA TEK 10-3 (2003), Table 2 (Maximum Spacing of Horizontal Reinforcement to Meet the Criteria $A_s > 0.0007 A_n$) for un-grouted or partially grouted walls vertical spacing of wire is 16 inches on center for eight- and 12-inch block. Additionally, Table 2 states the 16-inch spacing applies to nine-gauge wire with two wires (one wire per face shell of the block).

Rare is a CMU wall without frequently spaced vertical rebar and corresponding bond beam(s) with rebar encapsulated in grout.

Truss shape versus ladder shape

WHEN IT COMES TO USING horizontal joint reinforcement, it's no longer your father's Buick. In the beginning, truss was the norm for unreinforced masonry walls. As the NCMA TEK 12-2B implies, the truss shape is stiffer in the plane of the wall than the ladder shape, because of three wires (two longitudinal and one diagonal). However, most masonry walls are designed today to span in the vertical direction, hence, steel rebar and grout are placed vertically.

Rebar placement

When structural engineers design reinforced masonry, they typically call for the vertical bar to be placed in the center of block cells. The masonry code requires placement tolerance for vertical rebar to be +/- 1/2 inch (across the width of the block) and +/- two inches (along the length of the block) measured from the center of the block cell (Masonry Standards Joint Committee, The Masonry Society (TMS) 2011 Specification: Articles 3.4 B. 11. a & b).

Shape matters

Ladder-shaped wire has perpendicular cross-rods butt welded at 16 inches on center to the longitudinal wires. It's placed with cross-rods centered directly over the webs of the block (see Figure 1). Placement of ladder wire in this manner eliminates obstructions caused by diagonal cross-rods common

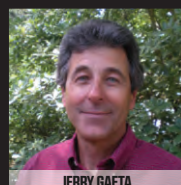

Figure 1. Ladder-shaped wire promotes code-required rebar centering, and does not get in the way of grout placement.

SEE MORE. LEARN MORE. PLAY MORE.
BE MORE PROFITABLE



750+ EXHIBITS HARDSCAPE DEMOS
NEW PRODUCTS FREE CONCERTS



JERRY GAETA



MONROE PORTER

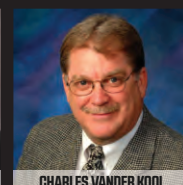

CHARLES VANDER KOOI

LEARN HOW FROM LEADING
INDUSTRY EXPERTS



HARDSCAPE
North America

DEALER PREVIEW DAY – OCTOBER 21, 2015

ALL ATTENDEES – OCTOBER 22-23, 2015

LOUISVILLE, KENTUCKY • KENTUCKY EXPOSITION CENTER

WWW.HARDSCAPENA.COM • (888) 580-9960

REGISTER TODAY AT
WWW.HARDSCAPENA.COM!

CO-LOCATED WITH



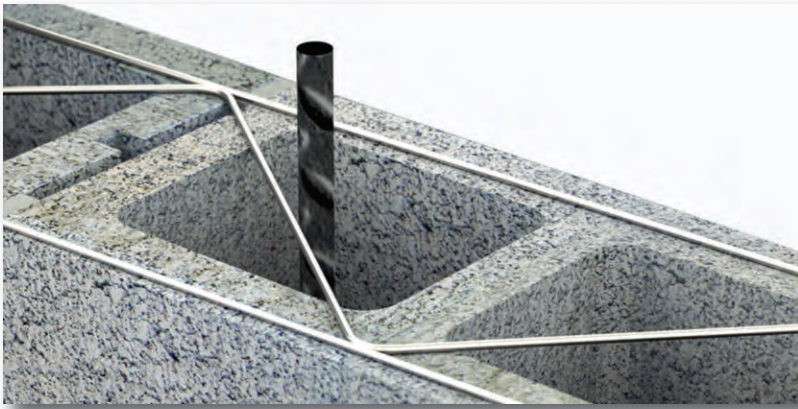

Figure 2. Truss-shaped wire interferes with code-required rebar centering, and may cause grout to hang up on the diagonal wires.

with the truss shape, especially where block cells are designed to contain vertical bars (see Figure 2).

Grout flow

Another advantage of ladder wire is evident when grout is placed and consolidated. The absence of diagonal (truss) cross wires improves the flow and consolidation of grout. Typically, the masonry code requires block (hollow units) to be placed so vertical cells to be grouted are aligned, which provides an unobstructed path for grout flow (TMS 2011 Specification: Article 3.3 B. 3. D). According to NCMA TEK 12-2B, "...because the diagonal cross wires may interfere with the placement of vertical reinforcing steel and grout, truss-type joint reinforcement should not be used in reinforced or grouted walls."

Shrinkage control

Ladder wire placed with cross rods centered directly over block webs has yet another distinctive advantage. It positions butt welded "T" intersections of each longitudinal wire with cross rods directly over "T" intersections, where block face shells meet each web. When laid in running bond pattern, two-cell block are placed with face shell (exterior and interior) mortar bedding only. Block webs are only mortar bedded adjacent to vertically reinforced cells. Face shell mortar bedding will extrude at the webs when compressed during block placement, completely encapsulating the wire "T" intersections, bonding the wire to the concrete masonry (see Figure 3). Hence, the net result should be improved shrinkage crack control.

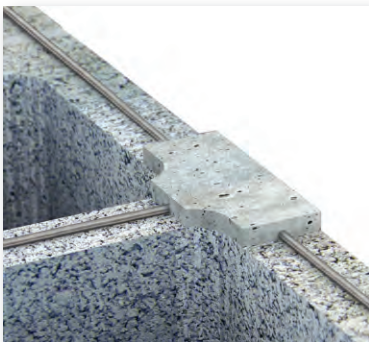

Figure 3. Ladder-shaped wire improves shrinkage control by forming interlocking Ts at cross webs.

Standard nine-gauge vs heavy-duty 3/16-inch

BESIDES ITS SHAPE (truss or ladder), wire thickness is important in the

placement process. The most common mortar joint thickness specified is 3/8 inch. The maximum wire diameter allowed by the masonry code would be one-half of the 3/8-inch mortar joint thickness, or 3/16 inch [TMS 2011 Code: Section 1.16.2.3]. However, there are compelling reasons to use the smaller size nine-gauge wire.

Placement tolerances

The masonry code tolerance for the placement of the mortar bed joint thickness is +/- 1/8 inch [TMS 2011 Specification: Article 3.3 F. 1. b.]. Therefore, a specified mortar joint of 3/8 inch would be allowed to vary from 1/2 to 1/4 inch in thickness. With an as-built mortar joint thickness of 1/4 to 3/8 inch, using

heavy-duty 3/16-inch wire with hot dip galvanized coating [TMS 2011 Code: Section 1.16.4.2] could leave inadequate room for mortar cover encapsulation (see Figure 4) when considering the galvanized coating, the levelness of the top surface of the CMUs supporting the wire and the planeness of the wire.

Quite literally, block could be placed directly on the wire (block on wire on block). According to an article by Mario J. Catani in the January 1995 Masonry Construction magazine entitled, "Selecting the Right Joint Reinforcement for the Job," he states, "One compelling reason to use nine-gauge reinforcement is for fit and constructability. While the code allows joint reinforcement to have a diameter one half the mortar joint width, the tolerances allowed for units, joints and the wire itself can hinder the placement of large diameter reinforcement. Use it only when there is no other choice."

Forming corners

THERE IS SOME DEBATE regarding the merits of ordering factory prefabricated inside and outside corners versus field-forming them. Since the TMS Code does not distinguish the merits of either method (and, indeed, barely recognizes them), some commentary is warranted. The industry standard for lapping wire reinforcement at any location is always the same: It requires at least six



Figure 4. Heavy-duty, 3/16-inch-diameter wire can leave inadequate room for proper mortar coverage. Both the top and bottom of wire could be in direct contact with masonry unit (no mortar coverage).

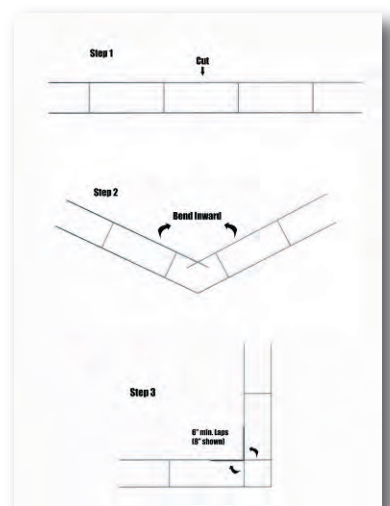

Figure 5. A simple, three-step sequence to field form corners

inches, whether lapping straight 10-foot sections one to another, or where a straight section meets a corner (TMS 2011 Specification: Article 3.4 B.10.b). This requirement also can be applied to field-formed corners. The inside longitudinal wire can be cut and bent to form a 90-degree angle with a minimum of six inches of lap paralleling the newly formed inside longitudinal wire (see Figure 5).

Factory-prefabricated corners may seem like the natural choice, but this can require additional lead time and cost for any size or configuration other than standard eight- or 12-inch, two-wire reinforcement. This is especially the case for custom-made adjustable hook-and-eye configurations.

Intersecting walls

TMS CODE ALLOWS prefabricated T-horizontal wire reinforcement sections, where an interior non-loadbearing masonry wall intersects another for lateral support. However, this may not be the best selection. Such T-sections are typically embedded 16 inches on center during construction in the longitudinal wall, leaving the projecting leg of the T-section

extending out about 24 inches until the intersecting wall is constructed.

Many masons will agree the exposed wire sections can be dangerous onsite, especially at eye height. Fortunately, the TMS Code also allows ¼-inch mesh galvanized hardware cloth for interior non-load-

bearing interesting walls (see Figure 6). Additionally, the TMS Code requires Z-strap anchors for walls that intersect where shear transfer is desired. Projecting Z-straps pose similar safety concerns with exposed T-sections.

However, they only need to be used when the design requires shear transfer, which is often misunderstood by the design community. When applicable, mesh ties are typically the best choice. They are readily available, simple, and economical to install, and can be safely bent out of the way until the intersecting wall reaches their height.

For intersecting interior loadbearing walls, lateral support is usually achieved from supporting framing members, and is not dependent on intersecting walls for lateral support.

Finish options

THE TWO MOST COMMON finishes for wire reinforcement are mill galvanized and hot-dip galvanized. The first category is allowed by the TMS Code for most interior applications not in contact with moisture or high humidity. Standard mill galvanized finishes are produced through electro-galvanization, a process where a layer of zinc is bonded to steel when a current of electricity is run through a saline/zinc solution with a zinc anode and steel conductor. This process is

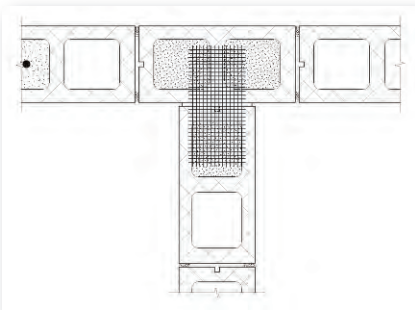

Figure 6. Code-approved mesh ties are safe, economical and readily available.

	LADDER	TRUSS
Superior shrinkage control	<input checked="" type="checkbox"/>	<input type="checkbox"/>
Full wall height cell clearance	<input checked="" type="checkbox"/>	<input type="checkbox"/>
Unobstructed vertical rebar centering	<input checked="" type="checkbox"/>	<input type="checkbox"/>
Free flow of grout & consolidation	<input checked="" type="checkbox"/>	<input type="checkbox"/>
	STANDARD (9 gauge)	HEAVY DUTY (3/16" dia.)
Fits within the Code tolerances	<input checked="" type="checkbox"/>	<input type="checkbox"/>
Superior shrinkage control	<input checked="" type="checkbox"/>	<input type="checkbox"/>
	MILL GALV.	HOT DIP
Interior exposure	<input checked="" type="checkbox"/>	<input type="checkbox"/>
Exterior exposure	<input type="checkbox"/>	<input checked="" type="checkbox"/>
Interior exposed to high humidity	<input type="checkbox"/>	<input checked="" type="checkbox"/>
	FACTORY CORNERS	FIELD FORMED CORNERS
Fit	<input checked="" type="checkbox"/>	<input checked="" type="checkbox"/>
Performance	<input checked="" type="checkbox"/>	<input checked="" type="checkbox"/>
Economy	<input type="checkbox"/>	<input checked="" type="checkbox"/>
Availability	<input type="checkbox"/>	<input checked="" type="checkbox"/>
Minimize waste	<input type="checkbox"/>	<input checked="" type="checkbox"/>
	FACTORY T'S	MESH TIES
Performance	<input checked="" type="checkbox"/>	<input checked="" type="checkbox"/>
Safety	<input type="checkbox"/>	<input checked="" type="checkbox"/>
Economy	<input type="checkbox"/>	<input checked="" type="checkbox"/>

Figure 7. This guide outlines joint reinforcement selection.

undertaken when wire is in its raw state, before fabrication (i.e. cut and welded to shape) into wire reinforcement.

Hot-dip galvanization is required for all exterior applications, as well as any interior walls exposed to moisture or high humidity. It is a process of coating steel with a heavy layer by immersing it in a bath of molten zinc. This process is undertaken after wire is fabricated to form reinforcement.

In a few unique applications, stainless steel might provide value. Though very expensive, it may be necessary in high-corrosive environments or where non-magnetic requirements are necessary.

Myriad advantages

UNFORTUNATELY, not all who design or specify wire reinforcement have kept pace with the shift to reinforced CMU. There are many pockets of the country where antiquated truss shape and/or heavy-duty wire are still in use. Figure 7 reviews the advantages of ladder and disadvantages of truss, along with standard nine-gauge versus heavy-duty wire reinforcement.

Additionally, ladder-shaped wire with nine-gauge side- and cross-rods has other advantages including lower production, packaging and shipping costs. Lighter bundle weight reduces risk of back injury when they are handled on the jobsite. Ladder configuration also streamlines wire, rebar and grout installation. This, in turn, enhances bricklayer productivity.

Generic specifications

THE FOLLOWING, and Figure 8, provide an example of the recommended wording for horizontal joint reinforcement in single- and multi-wythe masonry walls:

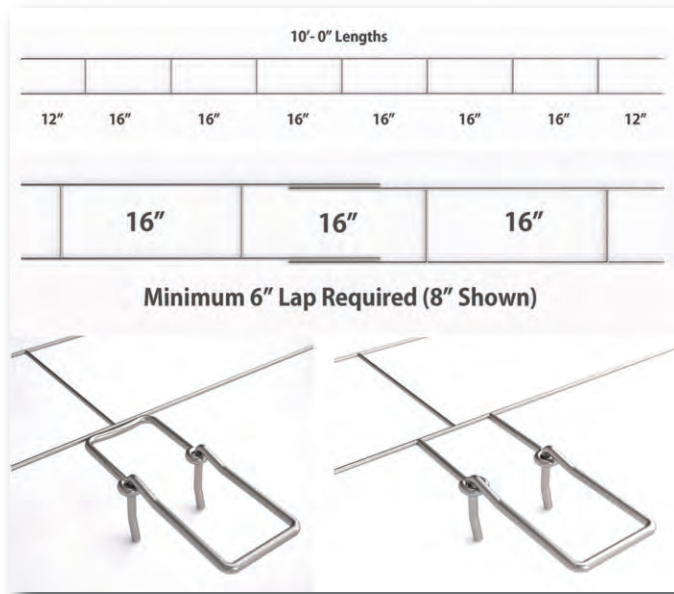

Figure 8. Ladder-shaped wire, code-required minimum lap, and butt-welded adjustable eye options are shown here.

Part 2 products

2.1 Masonry Reinforcing

A. Joint Reinforcement, General: ASTM A 961

1. Interior Walls: Mill galvanized, ASTM A 641 (0.10 ounces per square foot), carbon steel
2. Exterior Walls: Hot-dip galvanized, ASTM A 153 Class B-2 (1.50 ounces per square foot) carbon steel
3. Interior Walls Exposed to High Humidity: Hot-dip galvanized, ASTM A 153 Class B-2 (1.50 ounces per square foot) carbon steel
4. Wire Size and Side Rods: W1.7 or 0.148-inch-diameter (nine-gauge)
5. Wire Size and Cross Rods: W1.7 or 0.148-inch-diameter (nine-gauge)
6. Wire Size for Veneer Ties: W2.8 or 0.1875-inch-diameter (3/16 inch)
7. Spacing for Cross Rods: 16 inches on center
8. Provide in lengths of 10 feet

B. Masonry Joint Reinforcement for Single-Wythe Masonry: Ladder type with single pair of side rods

C. Masonry Joint Reinforcement for Multi-Wythe Masonry: Ladder type with adjustable (two-piece) design, with separate double-eye butt welded to side rods 16 inches on center; double hook ties that engage eyes welded to reinforcement and resist movement perpendicular to wall. Hook tie length shall be sufficient to extend 1/2-inch minimum into outer face shell for hollow units and 1.5-inch minimum into solid units, but with a minimum 5/8-inch cover at outside face.

Conclusion

MASON CONTRACTORS can positively impact the constructability, performance and cost effectiveness of their projects, all with the added benefit of upgrading the designer's specifications to better meet code requirements.

To control potential shrinkage cracking in a concrete masonry wall, it requires proper placement of the control joints and horizontal joint reinforcement. Horizontal joint reinforcement in a CMU wall does not prevent cracking, but, rather, controls it. Without it in a concrete masonry wall, shrinkage cracks may be visible and of a size more easily penetrable by Mother Nature.

With nine-gauge, ladder-shaped joint reinforcement in a concrete masonry wall, the longitudinal wire goes into tension as the concrete masonry is shrinking. Hence, an occasional microscopic crack should not be noticeable and would be less vulnerable to the elements. Use of truss-shaped wire that must be altered to fit around vertical reinforcing may not meet code compliance and may negatively impact the integrity of a reinforced concrete masonry wall system.

In summary, with respect to the statement "could undermine the capacity to meet code," consider the following: Ladder wire, when placed correctly, will not interfere with the minimum code requirement for placement tolerances of the vertical bar. Ladder wire, when placed correctly, will not interfere with meeting the minimum code requirements for placing and consolidating grout. Standard nine-gauge wire would leave more room for mortar cover encapsulation, when the mortar bed joint thickness is constructed within the minimum code tolerances.

When it comes to masonry wire reinforcement, the old adage "less is more" holds true. Ladder wire, fabricated in 10-foot lengths with nine-gauge continuous side rods and butt welded nine-gauge cross-rods spaced 16 inches on center is the ideal for high-performance CMU wall systems.

Field-formed corners and mesh ties at intersections offer greater performance, economy and safety. Meet code and performance requirements with standard mill galvanized for interior and hot-dip galvanized for exterior and high-moisture or humid environments. **IMAS**

Dan Zechmeister, PE, AIA Detroit Honorary Affiliate, FASTM, has been executive director and structural services director of the Masonry Institute of Michigan (MIM) since 1990. MIM provides detailing and technical assistance to the architectural and engineering community in Michigan and Northwest Ohio. Zechmeister is an active member of ASTM. He can be contacted at dan@masonryinfo.org.

Jeff Snyder has been president of MASONPRO Inc. since 1988. MASONPRO provides specialty accessories to unit mason contractors in the U.S. and Canada. His masonry field experience includes project managing for mason contractors in Texas and New Mexico. Snyder is a trustee with the Masonry Institute of Michigan and serves on their Generic Wall Design Committee. He can be contacted at jeff@masonpro.com.